

Expandoit™
Attachment System

AQTT-03

**TILLER ATTACHMENT
OPERATOR'S MANUAL**

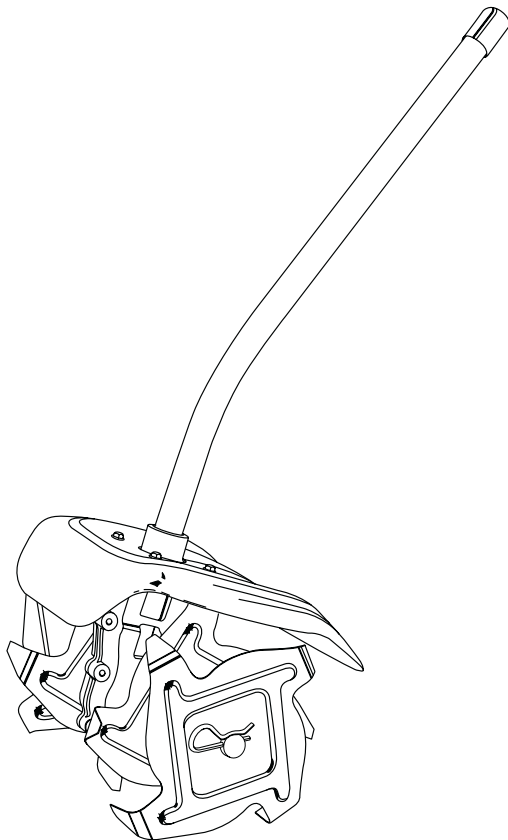

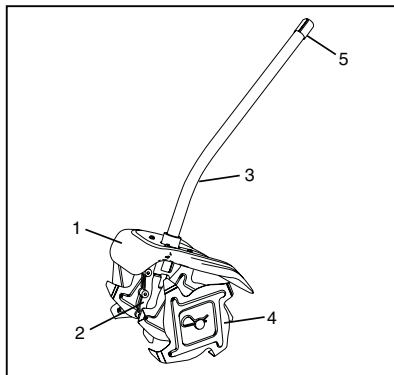

Fig. 1

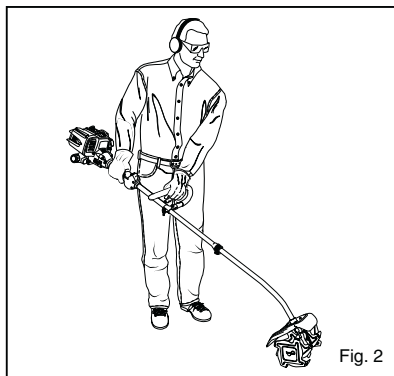
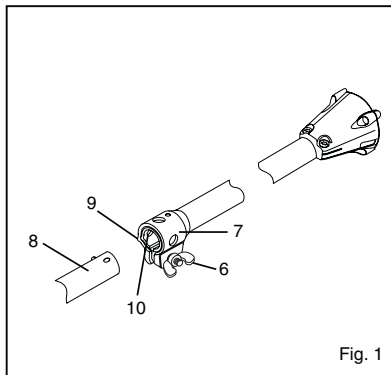

Fig. 2

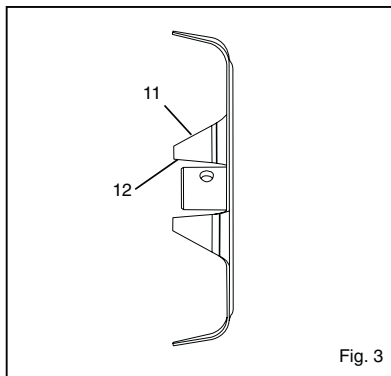

Fig. 3

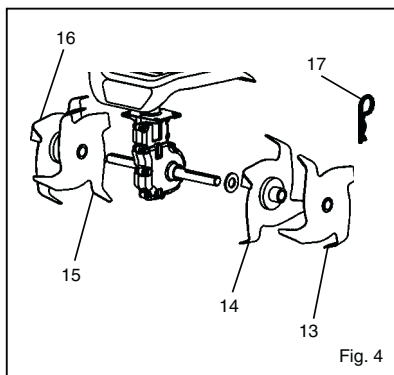

Fig. 4

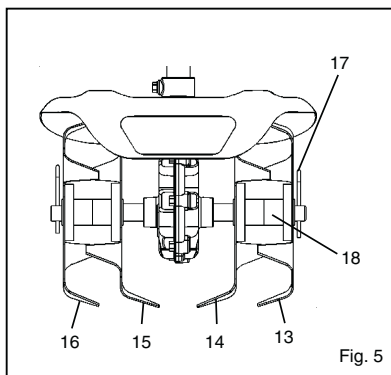
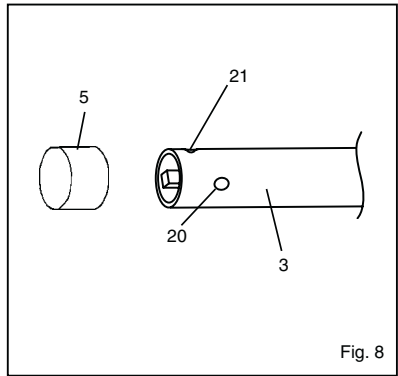
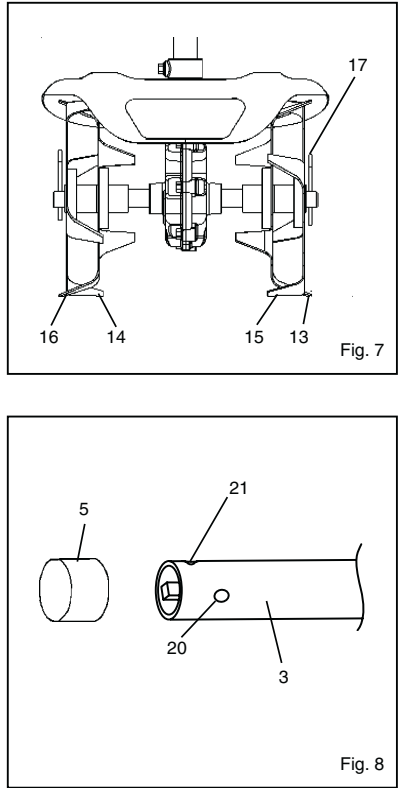
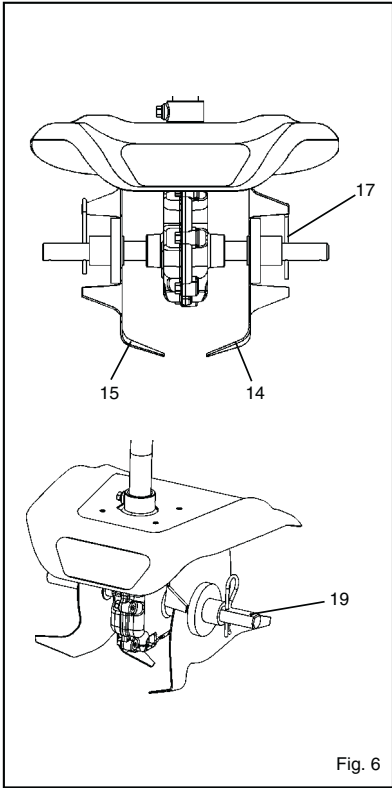

Fig. 5



Important!

It is essential that you read the instructions in this manual before mounting and operating this machine.

Subject to technical modifications

SAFETY RULES



WARNING

Read and understand all instructions. Failure to follow all instructions listed below, may result in electric shock, fire and/or serious personal injury.

SAVE THESE INSTRUCTIONS.

GENERAL SAFETY RULES

- For safe operation, read and understand all instructions before using the straight shaft trimmer attachment. Follow all safety instructions. Failure to follow all safety instructions listed below, can result in serious personal injury.
- Do not allow children or untrained individuals to use this unit.
- Wear safety glasses or goggles that are marked to comply with ANSI Z87.1 standards and hearing protection when operating this unit.
- Wear heavy long pants, boots, and gloves. Do not wear loose fitting clothing, short pants, jewelry of any kind, or go barefoot.
- Secure long hair so it is above shoulder level to prevent entanglement in any moving parts.
- Keep all bystanders, children, and pets at least 15 m away.
- Do not operate this unit when you are tired, ill, or under the influence of alcohol, drugs, or medication.
- Do not operate in poor lighting.
- Keep firm footing and balance. Do not overreach. Overreaching can result in loss of balance or exposure to hot surfaces.
- Keep all parts of your body away from any moving part.
- Do not touch areas around the muffler or cylinder of the power head, these parts get hot from operation. Failure to do so could result in possible serious personal injury.
- Always stop the engine and remove the spark plug wire before making any adjustments or repairs except for carburetor adjustments.
- Inspect unit before each use for loose fasteners, damaged or missing parts. Correct before using the straight shaft trimmer attachment. Failure to do so can cause serious injury.
- Check for damaged parts. Before further use of the appliance, any part that is damaged should be carefully checked to determine that it will operate properly and perform its intended function.

Check for alignment of moving parts, binding of moving parts, breakage of parts, mounting, and any other conditions that may affect its operation. A guard or other part that is damaged should be properly repaired or replaced by an authorized service center.

- Use only original manufacturer's replacement parts. Failure to do so, may cause poor performance, possible injury, and will void your warranty.
- Do not, under any circumstance, use any attachment or accessory on this product which was not provided with the product or identified as appropriate for use with this product in the Operator's Manual.

SPECIFIC SAFETY RULES FOR TILLER USE

- Rotating tines can cause severe injury, keep all body parts away from rotating tines.
- Use extreme caution when reversing or pulling the machine towards you.
- Always be sure of your footing; keep a firm hold on the handles and walk; never run.
- If the tiller should start to vibrate abnormally or become noisy, stop the motor and check immediately for the cause. Abnormal noise is generally a warning of trouble.
- Keep all fasteners tight to be sure the tiller is in safe working condition.
- Check that the cotter pins are fully inserted on the tine shaft before each use.
- Do not operate power equipment after it has been dropped or damaged. Return it to your nearest authorized servicing dealer for inspection and repair.
- Stop the engine whenever you leave the tiller, or when making any repairs or inspections.
- Make sure all proper guards and other safety devices are properly and securely attached before using this product.
- Be extremely careful when tilling in hard ground. The tines could catch in the ground and propel the tiller forward.
- Do not overload the capacity of the machine by attempting to till too deep at too fast a speed.
- Inspect the area where the equipment is to be used and remove all foreign objects.
- Keep hands, feet, and other body parts away from rotating parts.
- Always stop the engine and remove the spark plug wire before installing attachments, or making any adjustments.

English





SAFETY RULES

- Before storing the unit, allow the engine to cool.

- When not in use, store your tiller in a dry place which is inaccessible to children.

SYMBOLS

Important: Some of the following symbols may be used on your tool. Please study them and learn their meaning. Proper interpretation of these symbols will allow you to operate the tool better and more safely.

SYMBOLS	NAME	EXPLANATION
	Safety Alert Symbol	Indicates danger, warning or caution. it means attention!!! Your safety is involved.
	Read Your Operator's Manual	Your manual contains special messages to bring attention to potential safety concerns as well as operating and servicing information. Please read all the information carefully to ensure satisfaction and safe use.
	Wear eye and hearing protection	Wear eye, and hearing protection when operating this equipment.
	Ricochet	Danger of Ricochet.
	Cutting hazard	Keep feet and hands away from rotating tines.

DESCRIPTION

1. Shield
2. Gear Box
3. Tiller Attachment Shaft
4. Tines
5. End Cap
6. Knob
7. Coupler
8. Tiller Attachment
9. Guide Recess
10. Positioning Hole
11. Angled
12. Straight
13. Tine Blade A
14. Tine Blade B
15. Tine Blade C
16. Tine Blade D
17. Cotter Pin
18. Hub
19. Alternate Hole
20. Button
21. Hanger Hole

ASSEMBLY

JOINING THE POWER HEAD TO THE TILLER ATTACHMENT (Fig. 1)



WARNING

Never attach or adjust any attachment while power head is running. Failure to stop the engine may cause serious personal injury.

The tiller attachment (8) connects to the power head by means of a coupler device.

- Loosen the knob (6) on the coupler (7) of the power head shaft and remove the end cap (5) from the attachment shaft.
- Push in the button located on the tiller attachment shaft. Align the button with the guide recess (9) on the power head coupler and slide the two shafts together. Rotate the tiller attachment shaft until the button locks into the positioning hole (10).

NOTE: If the button does not release completely in the positioning hole, the shafts are not locked into place. Slightly rotate from side to side until the button is locked into place.

- Tighten the knob securely.

ASSEMBLY



WARNING

Be certain the knob is fully tightened before operating equipment; check it periodically for tightness during use to avoid serious injury.

REMOVING THE ATTACHMENT FROM THE POWER HEAD

For removing or changing the attachment:

- Loosen the knob.
- Push in the button and twist the shafts to remove and separate ends.

OPERATION

OPERATING THE TILLER (Fig. 2)

Hold the tiller attachment with the right hand on the rear handle and the left hand on the front handle. Keep a firm grip with both hands while in operation.

In nearly all types of soil, it is not necessary or recommended to operate the tiller attachment at full throttle. Doing so consistently will shorten the life of the engine and drivetrain. Partial throttle will usually be sufficient.



WARNING

Keep hands and feet away from the rotating tines. Rotating tines will cause serious personal injury.

NOTE: The tines of the tiller may rotate when the engine is started.

- Move the tiller to the work area before starting the engine.
- With the tiller on flat level ground. Start the engine of the power head; refer to the operator's manual of your power head.
- Hold the handles firmly, depress the throttle trigger to increase the engine speed to a moderate speed, then lower the tiller so the tines can make contact with the ground.
- Pull the tiller carefully toward you while it is digging into the soil's surface.

NOTE: Pulling the tiller carefully toward you while it is digging into the soil will reduce your effort and make the tilling easier.



WARNING

To avoid personal injury never carry the tiller while the engine is running. Move the tiller to the work area before starting the engine.



WARNING

After extended periods of use, the tiller gearbox may become hot. To avoid burns, do not touch the gearbox until it has had time to cool down.

TINE DIRECTION (Fig. 3)

When the tines are properly mounted, the angled portion of the tine blade should enter the soil first, not the straight portions.

TINE ADJUSTMENT (Fig. 4)

Tine blades are marked with the corresponding letters (13, 14, 15 & 16).

NOTE: All four tines on this unit are different and must be installed correctly or the tiller will not function properly. Refer to "Tine Direction" earlier in this manual.



CAUTION

Wear heavy gloves when installing, removing or adjusting the tiller tines. With wear, the tiller tines may become sharper.



WARNING

Stop the engine and disconnect the spark plug wire before adjusting the tiller tines.

NOTE: Do not force the tines on or off of the shaft. If you experience difficulties when removing the tines, apply some penetrating oil on the shaft. When reinstalling the tines, make sure to clean and oil the shaft and the tine hubs.

TINE PATTERNS

TINE PATTERN – REGULAR TILLING PATTERN (Fig. 5)

For most applications, the regular tine pattern will work best. This is the pattern set by the factory.

NOTE: Pay attention to the hub (18) position in relationship to the tines.

TINE PATTERN – NARROW TILLING PATTERN (Fig. 6)

When tilling in confined areas or rows, a narrow tine pattern may be required.

For a narrow tilling pattern, remove cotter pin (17) from each side of the tiller then remove the left and right outer tines (13 & 16) from each side. Replace cotter pin in alternate hole in shaft.

TINE PATTERN – STONY OR ROCKY SOIL TILLING PATTERN (Fig. 7)

If you are tilling in stony or rocky soil, and experience continual rock jams, there is an additional tine pattern

OPERATION

that will help correct the problem. In the stony soil tine pattern, the center gap is wider than in the regular tine pattern. This will require additional passes to till the area.

MAINTENANCE

TINE MAINTENANCE

1. Occasionally apply a few drops of oil to the shaft to keep the tines free on the shaft.
2. If tines are being replaced due to wear, all four tines should be replaced as a set.

STORING THE TILLER ATTACHMENT (Fig. 8)

Store the tiller attachment in a well-ventilated place that is inaccessible to children. Keep away from corrosive agents such as garden chemicals and de-icing salts.

To remove the tiller attachment from the power head for storage:

1. Loosen the knob on the coupler device.
2. Push the button (20) in, then twist the shafts to remove and separate the power head from the attachment.
3. When storing the tiller attachment, replace the end cap to keep dirt and debris out of the drive shaft.

NOTE: When using the hanger hole (21) to store the attachment, the end cap may only fit partially over the end of the shaft.

For storing information: Please refer to the operator's manual of your power head.

RYOBI TECHNOLOGIES AUSTRALIA PTY. LTD.

GUARANTEE



Subject to the guarantee condition below, this Ryobi tool (hereinafter called "the product") is guaranteed by Ryobi (hereinafter called "the Company") to be free from defects in material or workmanship for a period of 24 months from the date of original purchase covering both parts and labour. Under the terms of this guarantee, the repair or replacement of any part shall be the opinion of the Company or its authorised agent. Should service become necessary during the warranty period, the owner should contact the RYOBI HELPLINE 1300 361 505 or contact the retailer from whom the product was purchased.

In order to obtain guarantee service, the owner must present the sales docket and Guarantee Certificate to confirm date of purchase. This product is sold by the dealer or agent as principal and the dealer has no authority from the Company to give any additional guarantee on the Company's behalf except as herein contained or herein referred to.

Guarantee Conditions

This guarantee only applies provided that the Product has been used in accordance with the manufacturer's recommendations under normal use and reasonable care (in the opinion of the Company) and such

guarantee does not cover damage, malfunction or failure resulting from misuse, neglect, abuse, or used for a purpose for which it was not designed or is not suited and no repairs, alterations or modifications have been attempted by other than an Authorised Service Agent. This guarantee will not apply if the tool is damaged by accident or if repairs arise from normal wear and tear.

The Company accepts no additional liability pursuant to this guarantee for the costs of travelling or transportation of the Product or parts to and from the service dealer or agent - such costs are not included in this guarantee.

Certain legislation, including the Trade Practices Act, 1974 (as amended) and other state and territorial laws give rights to the buyer and impose liability on the seller in certain circumstances. Nothing herein shall have the effect of excluding, restricting or modifying any condition, guarantee, right or liability imposed, to the extent only that such exclusion, restriction or modification would render any term herein void.

RYOBI.

RYOBI TECHNOLOGIES AUSTRALIA PTY. LTD.

A.B.N. 98 002 277 509

SYDNEY: Building B, Rosehill Industrial Estate, 3-5 Shirley Street, Rosehill N.S.W. 2142

Contact during normal business hours.

Tel: 1300 361 505 - Fax: 1800 807 993 - www.ryobi.com.au

BRISBANE : All enquiries Tel : 1300 361 505
TOWNSVILLE: All enquiries Tel : 1300 361 505
MELBOURNE: All enquiries Tel : 1300 361 505

HOBART: All enquiries Tel : 1300 361 505
ADELAIDE: All enquiries Tel : 1300 361 505
PERTH: 33-35 Sorbonne Cres. Canning Vale, W.A. 6155
Tel : (08) 9455 7775

RYOBI NEW ZEALAND PTY. LTD.

AUCKLAND: 27 Clemow Drive, Mt Wellington, N.Z.

Tel: (09) 573 0230 - Free Call: 0800 279 624 - Fax: (09) 573 0231 - www.ryobi.co.nz

Contact during normal business hours.

This Guarantee Form Should Be Retained By The Customer At All Times

For your record and to assist in establishing date of purchase (necessary for in-guarantee service) please keep your purchase docket and this form completed with the following particulars.

Address Of Dealer _____

Date _____ Model No _____ Serial No _____

Present This Form With Your Purchase Docket When Guarantee Service Is Required.