

TECHTRONIC INDUSTRIES AUSTRALIA PTY LIMITED
GUARANTEE



Subject to the guarantee condition below, this Ryobi tool (hereinafter called "the product") is guaranteed by TECHTRONIC INDUSTRIES AUSTRALIA PTY LIMITED (hereinafter called "the Company") to be free from defects in material or workmanship for a period of 24 months from the date of original purchase covering both parts and labour. Under the terms of this guarantee, the repair or replacement of any part shall be the opinion of the Company or its authorised Service centre. Should service become necessary during the warranty period, the owner should contact the customer service HELPLINE 1300 361 505 or contact the retailer from whom the product was purchased. In order to obtain guarantee service, the owner must present the sales docket and Guarantee Certificate to confirm date of purchase. This product is sold by the dealer or Service centre as principal and the dealer has no authority from the Company to give any additional guarantee on the Company's behalf except as herein contained or herein referred to.

tee does not cover damage, malfunction or failure resulting from misuse, neglect, abuse, or used for a purpose for which it was not designed or is not suited and no repairs, alterations or modifications have been attempted by other than an Authorised Service centre. This guarantee will not apply if the tool is damaged by accident or if repairs arise from normal wear and tear. The Company accepts no additional liability pursuant to this guarantee for the costs of travelling or transportation of the Product or parts to and from the service dealer or Service centre - such costs are not included in this guarantee. Certain legislation, including the Trade Practices Act, 1974 (as amended) and other state and territorial laws give rights to the buyer and impose liability on the seller in certain circumstances. Nothing herein shall have the effect of excluding, restricting or modifying any condition, guarantee, right or liability imposed, to the extent only that such exclusion, restriction or modification would render any term herein void.

Guarantee Conditions

This guarantee only applies provided that the Product has been used in accordance with the manufacturer's recommendations under normal use and reasonable care (in the opinion of the Company) and such guaran-



TECHTRONIC INDUSTRIES AUSTRALIA PTY LIMITED

A.B.N. 98 002 277 509

SYDNEY: Building B, Rosehill Industrial Estate, 3-5 Shirley Street, Rosehill N.S.W. 2142
Contact during normal business hours.

Tel: 1300 361 505 - Fax: 1800 807 993 - www.ryobi.com.au

ALL AUSTRALIAN ENQUIRIES TEL : 1300 361 505

TECHTRONIC INDUSTRIES N.Z. LIMITED

AUCKLAND: 27 Clemow Drive, Mt Wellington, N.Z.

Tel: (09) 573 0230 - Free Call: 0800 279 624 - Fax: (09) 573 0231 - www.ryobi.co.nz
Contact during normal business hours.

This Guarantee Form Should Be Retained By The Customer At All Times

For your record and to assist in establishing date of purchase (necessary for in-guarantee service) please keep your purchase docket and this form completed with the following particulars.

Purchased From _____

Address Of Dealer _____

Date _____ Model No _____ Serial No _____

Present This Form With Your Purchase Docket When Guarantee Service Is Required.



EJS570FK

**JIGSAW
OWNER'S OPERATING MANUAL**



N197

DESCRIPTION

Components list

- | | |
|------------------------|-------------------------|
| 1. ON/OFF switch | 5. Blade holder |
| 2. Lock-on button | 6. Pendulum knob |
| 3. Speed control wheel | 7. Base plate |
| 4. Safety guard | 8. Dust extraction port |

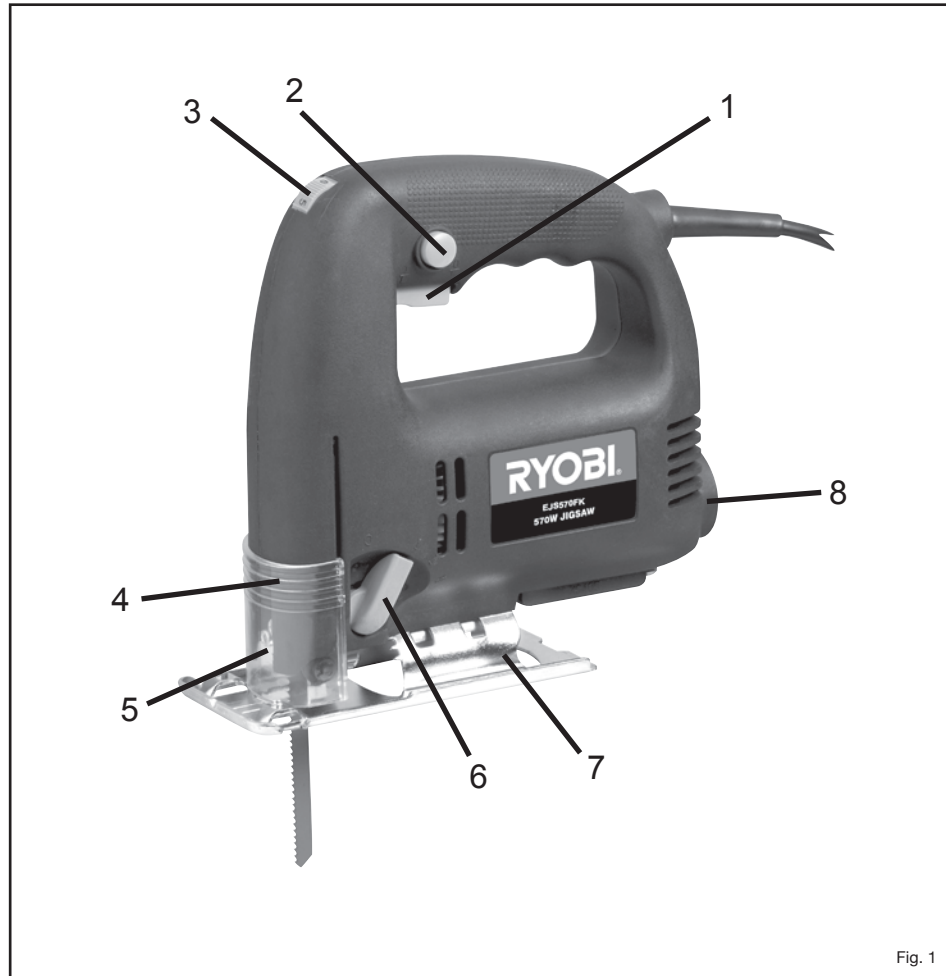

DESCRIPTION

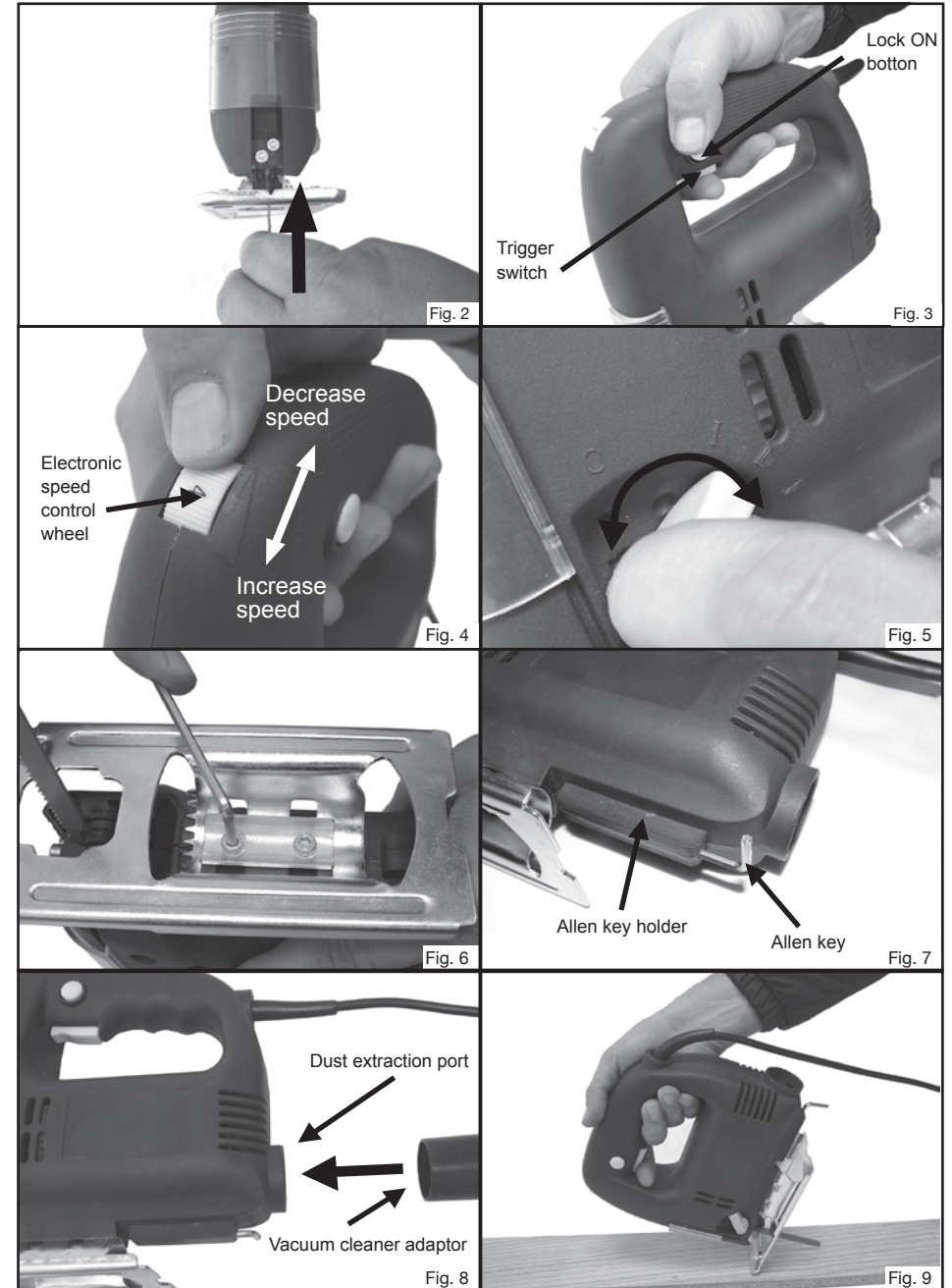

Please refer to pages 2 - 3 for instructions

Important!

It is essential that you read the instructions in this manual before operating this machine.

Subject to technical modifications

GENERAL POWER TOOL SAFETY WARNINGS



WARNING

Read all safety warnings and all instructions. Failure to follow the warnings and instructions may result in electric shock, fire and/or serious injury.

Save all warnings and instructions for future reference.

The term "power tool" in the warnings refers to your mains-operated (corded) power tool or battery-operated (cordless) power tool.

1) Work area

a) Keep work area clean and well lit.

Cluttered and dark areas invite accidents.

b) Do not operate power tools in explosive atmospheres, such as in the presence of flammable liquids, gases or dust. Power tools create sparks which may ignite the dust or fumes.

c) Keep children and bystanders away while operating a power tool. Distractions can cause you to lose control.

2) Electrical Safety

a) Power tool plugs must match the outlet. Never modify the plug in any way. Do not use any adaptor plugs with earthed (grounded) power tools. Unmodified plugs and matching outlets will reduce the risk of electric shock.

b) Avoid body contact with earthed or grounded surfaces such as pipes, radiators, ranges and refrigerators. There is an increased risk of electric shock if your body is earthed or grounded.

c) Do not expose power tools to rain or wet conditions. Water entering a power tool will increase the risk of electric shock.

d) Do not abuse the cord. Never use the cord for carrying, pulling or unplugging the power tool. Keep cord away from heat, oil, sharp edges or moving parts. Damaged or entangled cords increase the risk of electric shock.

e) When operating a power tool outdoors, use an extension cord suitable for outdoor use. Use of a cord suitable for outdoor use reduces the risk of electric shock.

f) If operating a power tool in a damp location is unavoidable, use a residual current device (RCD) protected supply. Use of an RCD reduces the risk of electric shock.

3) Personal safety

a) Stay alert, watch what you are doing and use common sense when operating a power tool. Do not use a power tool while you are tired or under the influence of drugs, alcohol or medication. A moment of inattention while operating power tools may result in a serious personal injury.

b) Use personal protective equipment. Always wear eye protection. Protective equipment such as dust mask, non-skid safety shoes, hard hat, or hearing protection used for appropriate conditions will reduce personal injuries.

c) Prevent unintentional starting. Ensure the switch is in the off-position before connecting to power source and/or battery pack, picking up or carrying the tool. Carrying power tools with your finger on the switch or energising power tools that have the switch on invites accidents.

d) Remove any adjusting key or wrench before turning the power tool on. A wrench or a key left attached to a rotating part of the power tool may result in personal injury.

e) Do not overreach. Keep proper footing and balance at all times. This enables better control of the power tool in unexpected situations.

f) Dress properly. Do not wear loose clothing or jewellery. Keep your hair, clothing and gloves away from moving parts. Loose clothes, jewellery or long hair can be caught in moving parts.

g) If devices are provided for the connection of dust extraction and collection facilities, ensure these are connected and properly used. Use of dust collection can reduce dust-related hazards.

4) Power tool use and care

a) Do not force the power tool. Use the correct power tool for your application. The correct power tool will do the job better and safer at the rate for which it was designed.

b) Do not use the power tool if the switch does not turn it on and off. Any power tool that cannot be controlled with the switch is dangerous and must be repaired.

c) Disconnect the plug from the power source and/or the battery pack from the power tool before making any adjustments, changing accessories, or storing power tools. Such preventative safety measures reduce the risk of starting the power tool accidentally.

GENERAL POWER TOOL SAFETY WARNINGS

d) Store idle power tools out of the reach of children and do not allow persons unfamiliar with the power tool or these instructions to operate the power tool.

Power tools are dangerous in the hands of untrained users.

e) Maintain power tools. Check for misalignment of binding or moving parts, breakage of parts and any other condition that may affect the power tools' operation. If damaged, have the power tool repaired before use. Many accidents are caused by poorly maintained power tools.

f) Keep cutting tools sharp and clean.

Properly maintained cutting tools with sharp cutting edges are less likely to bind and are easier to control.

g) Use the power tool, accessories and tool bits etc., in accordance with these instructions, taking into account the working conditions and the work to be performed. Use of the power tool for operations different from those intended could result in a hazardous situation.

5) Service

a) Have your power tool serviced by a qualified repair person using only identical replacement parts. This will ensure that the safety of the power tool is maintained.

SPECIFIC SAFETY WARNINGS

Use clamps or other practical way to secure and support the workpiece to a stable platform. Holding the work by hand or against your body leaves it unstable and may lead to loss of control.

Hold power tools by insulated gripping surfaces when performing an operation where the cutting accessory may contact hidden wiring or its own cord. Cutting accessory contacting a "live" wire may make exposed metal parts of the power tool "live" and could give the operator an electric shock.

Know your power tool. Read operator's manual carefully. Learn its applications and limitations, as well as the specific potential hazards related to this power tool. Following this rule will reduce the risk of electric shock, fire or serious injury.

Always wear safety glasses with side shields. Everyday glasses have only impact resistant lenses. They are NOT safety glasses.

Following this rule will reduce the risk of eye injury.

Protect your lungs. Wear a face or dust mask if the operation is dusty.

Protect your hearing. Wear hearing protection during extended periods of operation.

If using an extension lead, ensure that the male and female plug connection is elevated and out of the way of any water contact.

SUGGESTIONS FOR PROPER USE OF THE JIGSAW

Cut at an even rate and take care not to overload the saw.

Excessive force on the saw will prevent the pendulum action operating correctly and reduce the cutting efficiency.

Drill a 12mm diameter hole to start an enclosed pocket cut.

When cutting tight curves, reduce or switch off the pendulum action.

The rip fence helps guide cuts along the grain (rip cut).

Together with a centre pin, the rip fence can also be used for cutting circles.

SPECIFICATIONS

Power input:	570 W
No load speed:	500-3,000 min ⁻¹
Stroke length:	18 mm
Cutting capacity:	Aluminium: 15 mm
	Steel: 8 mm
	Wood: 65 mm
Cutting angle range:	0° - 45°
Net weight:	2.00 kg

OPERATION

It is recommended that the tool always be supplied via a residual current device with a rated residual current of 30mA or less.

FITTING THE SAW BLADE (Fig.2)

Disconnect the unit from the power supply.

Push the saw blade shank as far back as possible into the saw blade holder.

Tighten both screws with the Allen key.

To release, turn both screws one turn anti-clockwise.

STARTING THE SAW (Fig.3)

The saw is started by pressing the on/off switch.

OPERATION

The switch can be maintained in the operating position by using the lock-on button. The lock-on button can be released by pressing the on/off switch once more.

ELECTRONIC SPEED REGULATION (Fig.4)

The electronic speed control wheel is used to programme the required saw speed. In this way the speed can be adapted to fit the material being worked.

Turn the knob forward to increase the speed. Number 6 being the highest speed.

Turn the knob backwards to decrease the speed. Number 1 being the slowest speed.

PENDULUM STROKE ADJUSTMENT (Fig.5)

Together with the electronic speed regulation, the pendulum stroke adjustment helps set the best combination of blade speed and aggressiveness needed to achieve a desired cut rate and fineness.

The pendulum knob is used to make the adjustment.

When using a knife blade, the pendulum setting should be 0.

We recommend the use of appropriate lubricants for cutting metal.

Use the following table to obtain the best pendulum stroke settings for the particular work to be carried out.

TYPE OF MATERIAL	SETTING	TYPE OF MATERIAL	SETTING
Sheet metal	0	Plastics	I - II
Steel	0 - I	Plywoods	0 - I
Aluminium	I - II	Wood	I - II

SAW BASE ADJUSTMENT FOR ANGULAR CUTTING

Disconnect the unit from the power supply.

Raise the safety guard and loosen the allen screws on the base plate with the allen key (Fig.6).

Pull the base plate backward and set the desired angular adjustment according to the scale or push the base plate forward for fixed locks at 0°, 15°, 30°, 45°.

Tighten the allen screw.

Always replace the allen key in the allen key holder above the base plate immediately after use. (Fig.7)

DUST EXTRACTION (Fig.8)

In order to improve dust extraction from the working surface, the saw has a saw dust blowing system which clears dust from the cutting line. In addition an adaptor can be used to connect to a dust extraction device. The adaptor is fitted into the outlet position at the rear of the jigsaw. The vacuum

extraction system will work most effectively when the safety guard is in its down position.



WARNING:

Never cover the air vents. They must be open at all times for proper motor cooling.

POCKET CUTTING

The saw blade can be inserted directly into a wood surface without first drilling a pilot hole thus eliminating drilling operation.

First measure and clearly mark the surface to be cut.

Then tip the saw forward so that the rounded tips of the base rests on the work surface, but with the blade well clear of it. (Fig.9)

Switch ON and move the saw in its tilted, up position until the moving blade is exactly over the chosen point of entry.

Lower the rear of the base towards the work maintaining a firm pivoting pressure in the base lip with the blade exactly on the line.

DO NOT move the saw forward along its cut until the saw blade has completely entered the material and the base comes to rest on its surface.

MAINTENANCE

This power tool normally requires no maintenance, however, lubricating the guide roller from time to time with a drop of oil will extend the life of the roller.

Do not make any adjustment while the motor is in motion.

Always disconnect the electrical cord from the power source before mounting a jigsaw blade, changing brushes, or lubricating.

After use, check your tool to keep it in top condition.

Clean out accumulated dust.

When the carbon brushes are worn to the standard line, they must be replaced.

SERVICE

Now that you have purchased your tool, should a need ever exist for repair parts or service, simply contact your nearest Ryobi Authorised Service Centre or other qualified service organisation. Be sure to provide all pertinent facts when you call or visit.