

RYOBI®

RHT-600R/RHT-700R

ELECTRIC HEDGE TRIMMER OPERATOR'S MANUAL

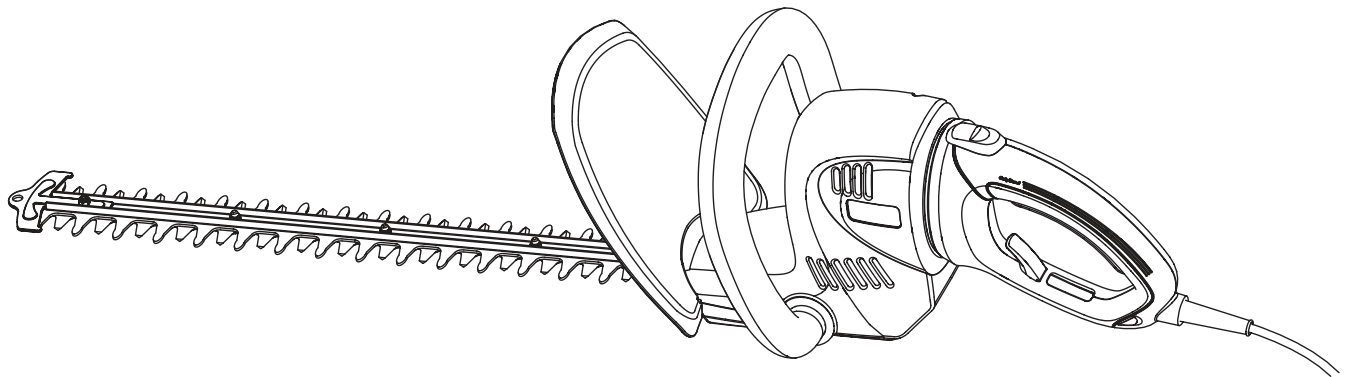

CE

✓
N197



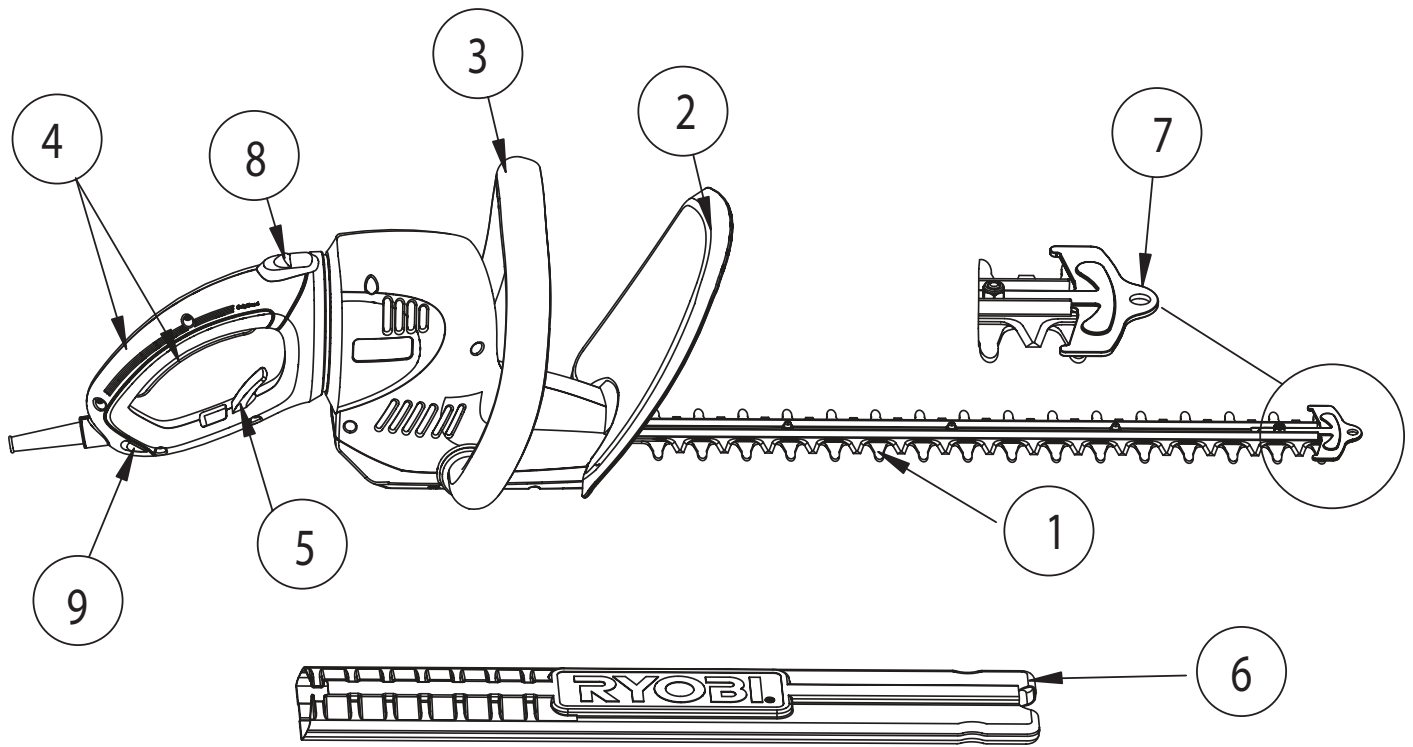

Fig. 1

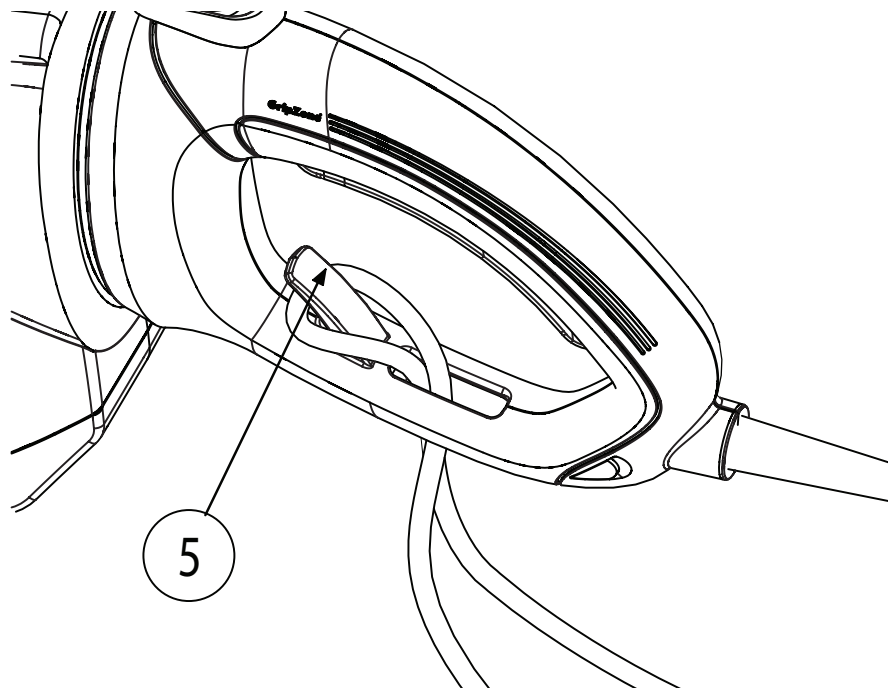

Fig. 2

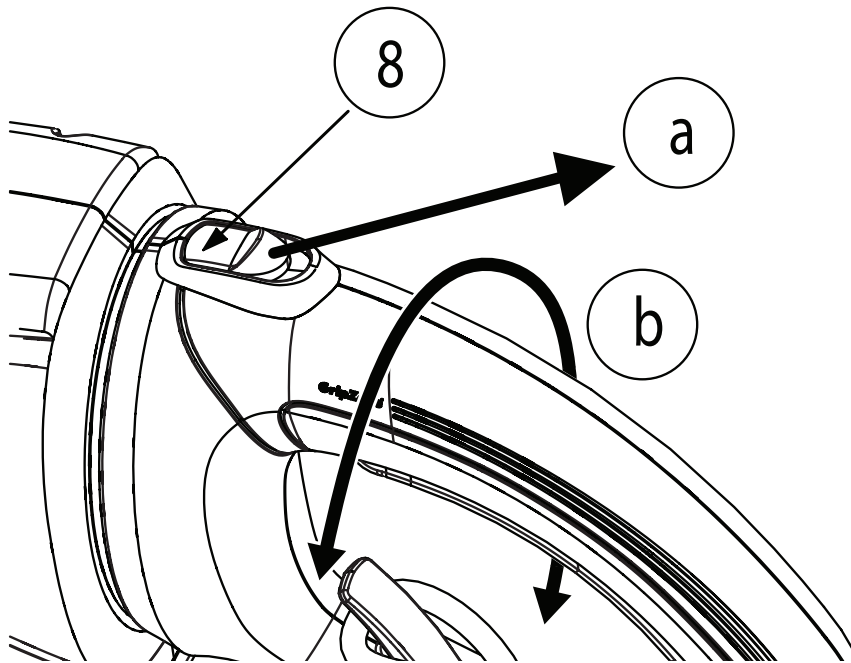

Fig. 3a

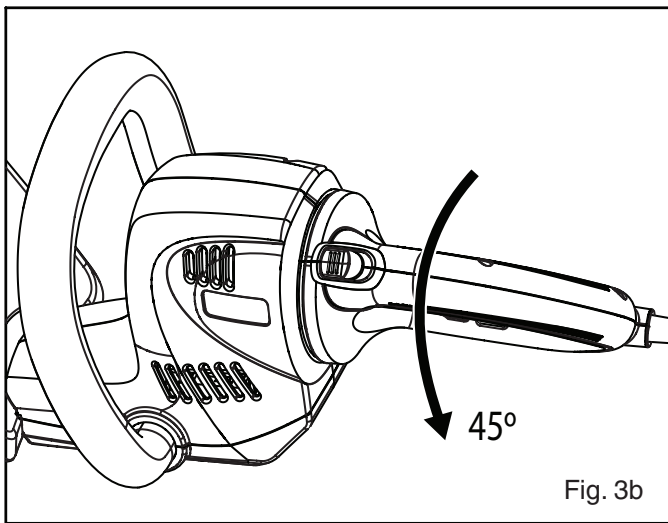

Fig. 3b

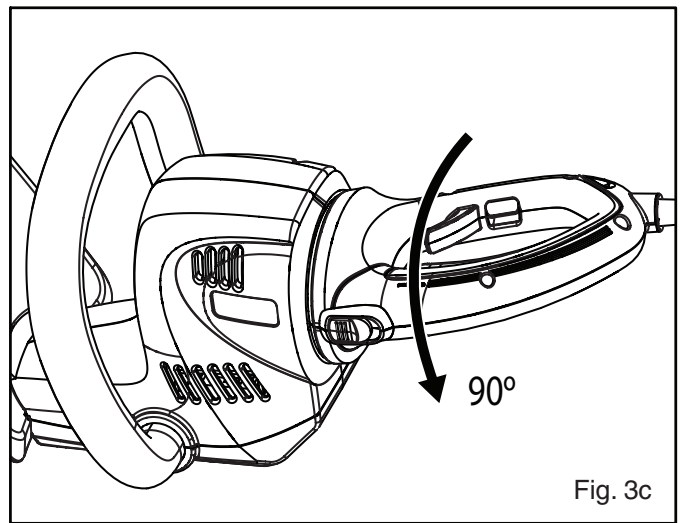

Fig. 3c

GENERAL SAFETY RULES



WARNING:

When using electric gardening appliances, basic safety precautions should always be followed to reduce the risk of fire, electric shock and personal injury, including the following:

READ ALL INSTRUCTIONS GENERAL SAFETY RULES

- Be familiar with the controls and proper use of the product.
- Clear the work area before each use. Remove all objects, such as rocks, broken glass, nails, wire or string that can lead to accidents.
- Wear heavy, long trousers, boots and gloves. Do not wear loose fitting clothing, shorts or go bare foot. Do not wear jewelry of any kind.
- Secure hair above shoulder level to prevent entanglement in moving parts.
- Do not allow children or untrained individuals to use this product.
- Keep all bystanders, especially children and domestic animals, at least 15m from the operating area. Stop this tool immediately if someone arrives in the working area.
- Do not operate this product when you are tired, ill or under the influence of alcohol, drugs or medication.
- Do not operate in poor lighting. Use the unit only in daylight or good artificial light.
- Keep firm footing and balance. Do not over reach. Overreaching can result in loss of balance or exposure to hazards.
- Keep all parts of your body away from moving parts. Inspect the product before use. Have any damaged parts replaced by your nearest Authorised Ryobi Service Centre before use.
- Do not operate the product in damp or wet locations.
- Do not use the product in the rain.
- Wear safety glasses or goggles when operating this product.
- Use the right product. Use the product for the intended purpose only.
- Do not handle the product with wet hands.
- Do not use the product if the switch does not turn the product on or off. A product that cannot be controlled with the switch is dangerous and must be repaired.
- Avoid accidental starting.
- Stay alert and pay attention to what you are doing. Use common sense when using this product.
- Do not force the product. It will do a better job with less likelihood of a risk of injury when you operate it at the rate

for which it was designed.

- Pull the plug out immediately if the mains or extension lead is damaged or severed.
- Disconnect the plug from the power supply when it is not in use, before carrying out any adjustment, servicing or maintenance.
- The appliance is not intended for use by young children or infirm persons without supervision.
- Young children should be supervised to ensure that they do not play with the appliance.

SPECIFIC SAFETY RULES

- Never operate the product without the safety guard in place and in good condition.
- Keep the working area free from wires, nails, metallic cable, glass, stones and debris.
- Do not cut against hard objects, this could cause injury or damage the trimmer.
- Do not cross roads or gravel paths with the trimmer still running.
- As equipment user, you are responsible for third parties in the working area.
- While operating the tool, always hold it firmly with both hands by the two handles and ensure a firm footing, especially if steps or ladders are used. Don't touch the blades!
- Make sure you hold the tool firmly with both handles and that you are well balanced with your weight evenly distributed on both feet.
- Keep the cutting system below level of your waist.
- Keep your fingers and other body parts away from the cutting blade.



CAUTION:

Certain parts of the machine may become hot in use.

- Familiarise yourself with your surroundings and be on the alert for possible hazards which you may not notice because of the noise from the machine.
- Never grasp the tool by the blade.
- Large variation in temperature can lead to condensation inside the tool. Before use, give the machine time to adjust to the temperature of work area.
- Let the tool work at its own pace. Do not overload.
- Never attempt to use an incomplete machine or one fitted with an unauthorised modification.
- When transporting, disconnect the plug from the mains. Carry the trimmer by the handles provided and keep hands away from the blade.
- During transport or storage always cover the with the blade sheath (6).

ENGLISH

SPECIFIC SAFETY RULES



WARNING:

NEVER USE THE TOOL WITHOUT THE SAFETY GUARD.

LET THE TOOL WORK AT ITS OWN PACE. DO NOT OVERLOAD.

ELECTRICAL SAFETY RULES

- Make sure the cord is located so that it will not be stepped on, tripped over or otherwise subjected to damage or stress.
- Connect the power lead to the mains only when no one is handling the tool.
- Do not abuse the power cord. Never carry the product by the cord. Never pull the plug out of the power point by the cord. Keep the cord away from heat, oil and sharp edges.
- For outdoor work use only suitably rain-water-proof approved extension cables.
- Secure the extension cable by hanging it in the pull relief(5)(Fig.2).
- Make sure there are no cuts, cracks or signs of deterioration in the power cable. If there are have the power cord replaced by an Authorised Ryobi Service Centre.
- A nameplate on the product indicates the unit's voltage. Never connect the product to an AC voltage that differs from this voltage.
- If the power cord or extension cable becomes damaged during use, disconnect the cord from the supply immediately. **DO NOT TOUCH THE CORD BEFORE DISCONNECTING THE SUPPLY.**
- Adopt protective measures against electrical shock. Avoid bodily contact with earthed parts such as metal pipes, radiators, cooking ranges, refrigerators and the like.
- Electrical power should be supplied via a Residual Current Device (RCD) with a tripping current of not more than 30mA.

MAINTENANCE RULES

- Unplug the product before making adjustments or repairs.
- Do not use the product if parts have been damaged. Check the product regularly to make sure that it will operate properly and perform the intended function. Any part that is damaged should be properly repaired or replaced by an Authorised Ryobi Service Centre.

- Never douse or squirt the product with water or any other liquid. Do not use detergents or solvents. Wipe down housing with a damp cloth only, then dry fully and make sure there is no debris remaining in the blade or working parts.
- Remove plug from socket before adjusting or maintaining tool.
- Always keep vent slits free of obstruction.
- After each use carefully clean the blade, rub over with an oily cloth or treat with an environmentally friendly lubricant.



WARNING:

Before carrying out any maintenance operations, cut off the electric power supply by disconnecting the plug from the mains.

SERVICE RULES

- Service on this product must be performed by qualified repair personnel only. Service or maintenance performed by unqualified personnel could result in injury to the user and/or damage to the product. Such service may also void your warranty.
- Use only identical replacement parts when servicing the product. Follow the instructions in the Maintenance section of this manual. Use of unauthorised parts or failure to follow maintenance instructions may create a risk of shock, serious injury to the user and/or damage to the product. Such use may also void your warranty.
- When replacing the blade the whole blade assembly should be changed.











STORAGE AND TRANSPORTATION RULES

- Stop the motor when you are waiting to cut or when you are walking from one cutting location to another. Store the product inside in a dry place.
- When transporting, disconnect the plug from the mains. Carry the trimmer by the handles provided and keep hands away from the cutting blade.
- During transport or storage always cover the blade with the blade sheath, so that the blades aren't accessible.
- The knock-on protector can, if required, also serve as a wall-mounted holder.
- Store the product up high or lock it up to prevent unauthorised use or damage. Keep the product out of the reach of children.
- Secure the product when transporting it.
- Save these instructions. Refer to them frequently and use them to instruct others who may use this product. If you loan someone this product, loan these instructions also.

ENGLISH

SYMBOLS

Some of the following symbols may be used on this tool. Please study them and learn their meaning for safe operation of this product.

SYMBOL	NAME	EXPLANATION
	Safety Alert	Precautions that involve your safety.
	Ricochet	Thrown objects can cause severe injury. Wear protective clothing and boots.
	Eye Protection	Always wear safety goggles or safety glasses with side shields or a full face shield when operating this product.
	Keep Bystanders Away	Keep all bystanders at least 15m away.
	Class II Construction	Double-insulated construction.
	Wet Conditions Alert	Do not expose to rain or use in damp locations.
	Read the Operator's Manual	To reduce the risk of injury, user must read and understand operator's manual before using this product.
	Electric Shock Precaution	Remove plug from the mains immediately if cable is damaged or cut
	Sound power level	RHT-600R Sound power level is 103dB
	Sound power level	RHT-700R Sound power level is 104dB

The following signal words and meanings are intended to explain the levels of risk associated with this product.

SYMBOL SIGNAL MEANING



DANGER:

Indicates an imminently hazardous situation which, if not avoided, will result in death or serious injury.



WARNING:

Indicates a potentially hazardous situation which, if not avoided, could result in death or serious injury.



CAUTION:

Indicates a potentially hazardous situation which, if not avoided, may result in minor or moderate injury.

CAUTION:

(Without Safety Alert Symbol) Indicates a situation that may result in property damage.

ENGLISH

SYMBOLS(CONTINUE)

DESCRIPTION

SERVICE

Servicing requires extreme care and knowledge and should be performed only by a qualified service technician. For service we suggest you return the product to your nearest AUTHORISED SERVICE CENTRE for repair. When servicing, use only identical replacement parts.



WARNING:

Observe all normal safety precautions related to avoiding electrical shock.



WARNING:

To avoid serious personal injury, do not attempt to use this product until you read thoroughly and understand completely the operator's manual. Save this operator's manual and review frequently for continuing safe operation and instructing others who may use this product.



WARNING:



The operation of any power tool can result in foreign objects being thrown into your eyes, which can result in severe eye damage. Before beginning power tool operation, always wear safety goggles or safety glasses with side shields and a full face shield when needed. We recommend Wide Vision Safety Mask for use over eyeglasses or standard safety glasses with side shields. Always use eye protection.

SAVE THESE INSTRUCTIONS

1. Blade
2. Safety Guard
3. Bow-grip With On/off Switch
4. Rotational Handle With On/off Switch
5. Pull Relief for cord
6. Blade sheath
7. Knock On Protector
8. Lock Button, Rotational Handle
9. LiveTool Indicator

TECHNICAL DATA

		RHT-600R	RHT-700R
Rated voltage	V~/Hz	220-240/50	220-240/50
Power rating	W	600	700
Rated no-load speed	min ⁻¹	1500	1500
Cutting capacity	mm	27	27
Blade length	mm	550	650
Braking time	s	<1	<1
Weight (without cable)	Kg	4.2	4.3
LpA(noise)	dB(A)	90	90
LWA(sounding power)	dB(A)	103	104
Vibration level	m/s ²	1.9	1.9

OPERATION

POWER CONNECTION

- The mains voltage must conform to the specifications on the rating plate.
- Connect the tool plug to an approved extension lead (if required) and protect the plug connection with the pull-relief (5) (Fig 2.).
- Once plugged to electric supply, the LiveTool Indicator (9) shows a blue light, which means this tool is ready for use.

RANGE OF USE

- Cutting and trimming of hedges, bushes and ornamental shrubs in the domestic sector only. All other uses are expressly excluded.

SWITCHING ON AND OFF

This tool is equipped with a two-hands safety switching system. This system prevents starting the tool inadvertently and will only allow operation while holding the tool with both hands.

- To Switch On: Press the bow grip On/Off switch (3) and the On/Off switch at rotational handle (4) with both hands at the same time.
- To Switch Off: Release On/Off switch (3) and/or rotational handle switch (4).
- The electric brake will stop the blade within one second. The sparking (flashing) resulting in the area of the vent slits / top of the main enclosure is normal and will not damage the tool.
- When you stop your equipment, be sure that the cutting system comes to complete stop before proceeding further.

NOTE:

- This tool cannot be started if the lock switch (8) is pulled backward and /or the rotational handle (4) is being turned.

ADJUSTING THE TURNING HANDLE

To facilitate your work the hedge trimmer is equipped with a turning rear handle that can be set in 5 different positions (Normal, +/- 45 and +/- 90 degrees). This mechanism provides ergonomically comfortable positions when cutting vertical or angled planes, avoiding early fatigue experienced with other hedge trimmers.

Follow below steps to change the position of the handle:

Release the On/Off switch (4), Pull the lock button (8) backward (Fig 3a.). The rotational handle is now unlocked and can be turned to the desired position (Fig 3b&3c). In the desired end position, release the lock button (8) back into place to secure the handle position.

Please bear in mind that the lock button (8) can only be pulled back when the On/Off switch (4) is not activated. Make sure that the lock button fully engages into the housing again after repositioning the turning handle. Only then can this tool be activated.

CUTTING HEDGES

- Clean up the cutting area before starting. Take away stones, glass pieces, nails, metallic cable and any objects that can be projected or get caught during the cutting.
- Using pruning shears, first prune out branches of a diameter greater than 27mm.
- Young buds can be trimmed easily with a scythe movement; older and bigger hedges can be trimmed easily with a sawing movement.
- The knock-on protector (7) prevents hazardous kickback from contact with walls, fences, etc.
- If hard objects become jammed in the cutter blade, switch off the tool immediately, pull out plug first and only then remove the objects.
- Metal objects such as wire fences and plant supports can damage the blade. Do not let the cutting blades come in contact with materials that can not be trimmed, such as stones or metal.
- Always lay the lead away from the working area. Always work away from the power socket. For this reason decide on the direction of cut before beginning work.

DISPOSAL

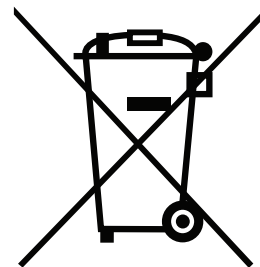

Waste electrical products should not be disposed of together with household waste. Please recycle where facilities exist. Check with your local authority or retailer for recycling advice.

RYOBI TECHNOLOGIES AUSTRALIA PTY. LTD.

GUARANTEE



Subject to the guarantee condition below, this Ryobi tool (hereinafter called "the product") is guaranteed by Ryobi (hereinafter called "the Company") to be free from defects in material or workmanship for a period of 24 months from the date of original purchase covering both parts and labour. Under the terms of this guarantee, the repair or replacement of any part shall be the opinion of the Company or its authorised agent. Should service become necessary during the warranty period, the owner should contact the RYOBI HELPLINE 1300 361 505 or contact the retailer from whom the product was purchased.

In order to obtain guarantee service, the owner must present the sales docket and Guarantee Certificate to confirm date of purchase. This product is sold by the dealer or agent as principal and the dealer has no authority from the Company to give any additional guarantee on the Company's behalf except as herein contained or herein referred to.

Guarantee Conditions

This guarantee only applies provided that the Product has been used in accordance with the manufacturer's recommendations under normal use and reasonable care (in the opinion of the Company) and such

guarantee does not cover damage, malfunction or failure resulting from misuse, neglect, abuse, or used for a purpose for which it was not designed or is not suited and no repairs, alterations or modifications have been attempted by other than an Authorised Service Agent. This guarantee will not apply if the tool is damaged by accident or if repairs arise from normal wear and tear.

The Company accepts no additional liability pursuant to this guarantee for the costs of travelling or transportation of the Product or parts to and from the service dealer or agent - such costs are not included in this guarantee.

Certain legislation, including the Trade Practices Act, 1974 (as amended) and other state and territorial laws give rights to the buyer and impose liability on the seller in certain circumstances. Nothing herein shall have the effect of excluding, restricting or modifying any condition, guarantee, right or liability imposed, to the extent only that such exclusion, restriction or modification would render any term herein void.

RYOBI®

RYOBI TECHNOLOGIES AUSTRALIA PTY. LTD.

A.B.N. 98 002 277 509

SYDNEY: Building B, Rosehill Industrial Estate
3-5 Shirley Street, Rosehill N.S.W. 2142

Tel: 1300 361 505 - Fax: 1800 807 993 - www.ryobi.com.au

BRISBANE : All enquiries Tel : 1300 361 505
TOWNSVILLE: All enquiries Tel : 1300 361 505
MELBOURNE: All enquiries Tel : 1300 361 505

HOBART: All enquiries Tel : 1300 361 505
ADELAIDE: All enquiries Tel : 1300 361 505
PERTH: All enquiries Tel : 1300 361 505

RYOBI NEW ZEALAND PTY. LTD.

AUCKLAND: 27 Clemow Drive, Mt Wellington, N.Z.

Tel: (09) 573 0230 - Free Call: 0800 279 624 - Fax: (09) 573 0231 - www.ryobi.co.nz

Contact during normal business hours.

This Guarantee Form Should Be Retained By The Customer At All Times

For your record and to assist in establishing date of purchase (necessary for in-guarantee service) please keep your purchase docket and this form completed with the following particulars.

Address Of Dealer _____

Date _____ Model No _____ Serial No _____

Present This Form With Your Purchase Docket When Guarantee Service Is Required.